

# AIR-CHANNEL® CLASSIC

## WITH SUBFLOOR



## STABILITY, PERFORMANCE AND LONGEVITY

Air Channel Classic takes commodity floating sleeper system technology and adds a whole new dimension of resilience and uniformity. This economical suspended system features enhanced pad components for added value in a basic commodity design. The double profiled, cavity-backed, 7/16" EPDM rubber Bio-Pads offers greater durability and higher performance values than most commodity pad designs.

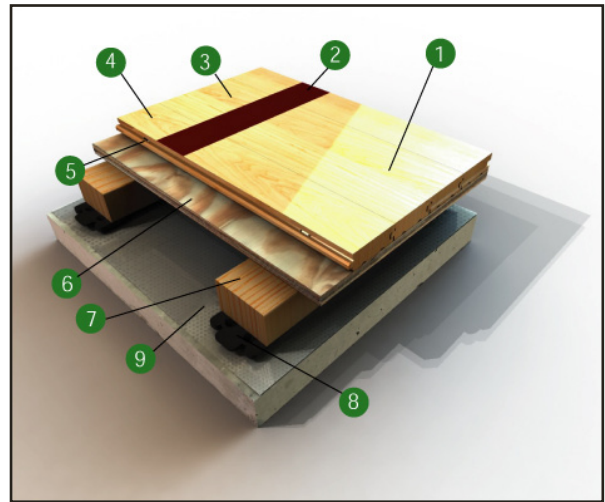

1. Finish: MFMA approved floor finish
2. Gamelines: Gameline Paint
3. Sealer: MFMA approved floor sealer
4. Flooring: Commodity 25/32" (20mm) Random Length (RL) Northern Hard Strip Maple or upgraded Continuous Strip® XL Finger-Jointed(FJ) Northern Hard Strip Maple
5. Flooring Fastener: 2" staples or flooring cleats
6. Subfloor: 1 layer of nominal 1/2" x 48" x 96" (12mm x 122 cm x 244cm) Exposure 1 rated subfloor sheathing stapled to sleepers
7. Sleeper: Nominal 2" x 3" x 4' long fir or pine.
8. Resilient Pad: 7/16" EPDM Bio-Pad
9. Vapor Barrier: 6- MIL polyethylene

### System Benefits:

- 7/16" (11mm) resilient EPDM Bio-Pad™ for shock absorption and vibration control
- Continuous Strip® XL Maple adds strength and provides a floor that can last up to 10 years longer than random-length strip
- Continuous subfloor provides uniformity & strength under bleacher loads and portable backstops
- High-Profile
- Economical
- Other pad options



robbinsfloor.com | 1.800.543.1913

Robbins, Inc. | 4777 Eastern Avenue | Cincinnati, OH 45226

MAPLE FLOORING SYSTEMS

# AIR-CHANNEL® CLASSIC WITH SUBFLOOR



## Product Specifications

System Type	Floating
Slab Depression	3 1/8" (79mm) with 25/32" (20mm) thick Maple 3 3/8" (86mm) with 33/32" (26mm) thick Maple
Surface- MFMA Northern Hard Maple	Robbins Continuous Strip® XL (FJ) or Random Length (RL)
LEED Contributions	MR credit 4, 5, & 7 IEQ 4.1, 4.2, 4.3, 4.4 FSC® Lumber Available <i>*Credits are based on products selected and location of facility</i>
Subfloor Construction	Sleeper with Subfloor
Resilience Layer	EPDM Bio-Pad
Optional Construction	Contact a Robbins Representative for Alternative Systems
Warranty 	1 year Industry Standard with optional Extended Warranty Program ( <i>Egis Floorlife</i> )
Air-Channel Family Reference Facilities	Oklahoma University University of Mississippi Robert F. Kennedy High School



Wall View

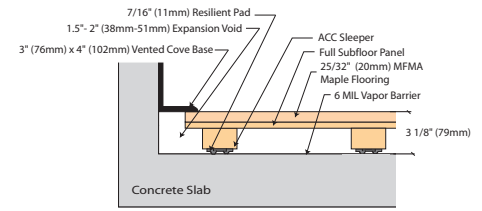

Threshold View

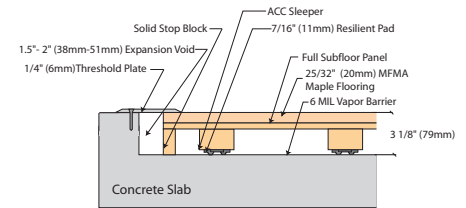

Equipment View

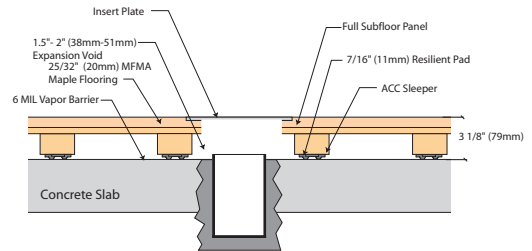

robbinsfloor.com | 1.800.543.1913

Robbins, Inc. | 4777 Eastern Avenue | Cincinnati, OH 45226

All Rights Reserved. © 2012 Robbins, Inc. ACCSF201206